



Established : 2001

Location : Turkiye/Izmir

Group Companies : 3

Fields & Activities of Group Companies

Engineering & Design
Machining & Weld Fabricated
Contract Manufacturing
Machine Key Manufacturing
Hydraulic Cylinder Manufacturing
Machine Manufacturing
Tapping Machines - Rotary Tables
Tool Grinding Machines – Clamping Acces.
Special Machines - Disinfection Machines

Group Companies

*Akıncı Machine Tools Ltd. - 1997
*Umut Kama Ltd. - 2010
*Imtek Machine Technologies A.S. - 2021

MemberShips	Remark
Izto - Izmir Chambre of Commerce	Corporate
Ebso - Aegean Region Chamber of Industry	Corporate
MIB - Turkish Machine Manufacrerer Association	Corporate
TIM - Turkish Exporter Assembly	Corporate
MMO - Chamber of Mechanical Engineers	Individual



Mechanical

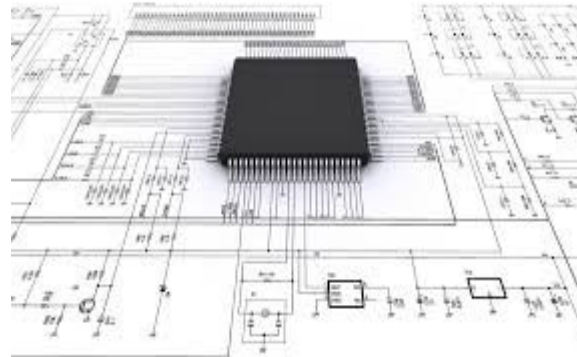

Electrical & Electronics

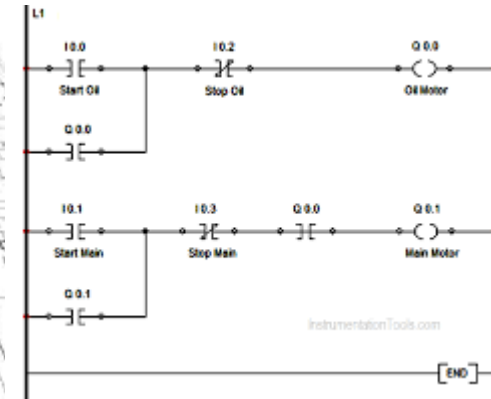

Software

Our Engineering and Design activities are based on traditional engineering practices, harmonized in mechanical, electrical, electronic and software disciplines, Cad/Cam/Cae/Reverse Engineering etc. carried out with the applications of modern engineering methods.

Our Abilities

Manufacturing

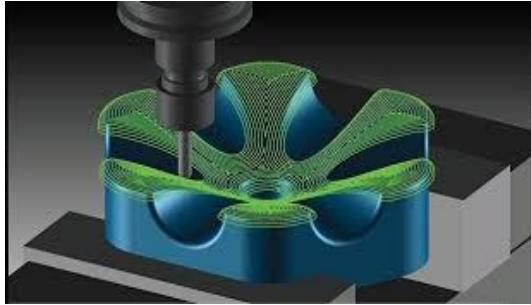

Cad/Cam/Cae/ Reverse Eng. App.

Designe, Solid Model, Technical drawing of Manufacturing & Assembly, Analyze, etc. modern engineering applications



Machining

Turning, Milling, Grinding etc. Machining operations are carried out by our experienced and well-equipped technical personnel in our machining workshops with conventional and modern multi-axis CNC machine tools.



Welding Contruction

Mig/Mag-Tig/Wig-Electric Arc, Laser etc. Welding applications are carried out in our construction workshops by our experienced and well-equipped technical staff, and if needed, under our control, by our specialized partners.



Sheet Metal Forming

Cutting, Bending, Curling etc. sheet metal forming operations, Laser cutting, CNC and Conventional press brakes etc. Machines are carried out under our control by our expert and well-equipped partners.



Preforming

Casting, Forging, Injection etc. Preforming operations are carried out under our control by our specialized partners with modern and up-to-date machines and systems.



Mold & Die

Wood, Styrofoam, Aluminum model manufacturing, Volume and Cutting Molds manufacturing are carried out under our control by CNC machine tools, in our machining workshops, by our experienced and well-equipped technical staff, and if needed, by our specialized partners.



Prototyping

Cad/Cam/Cae-Reverse Engineering, CNC Machine Tools, 3D Printer etc. It is carried out by our experienced and well-equipped technical team in our R&D, P&D and manufacturing workshops.

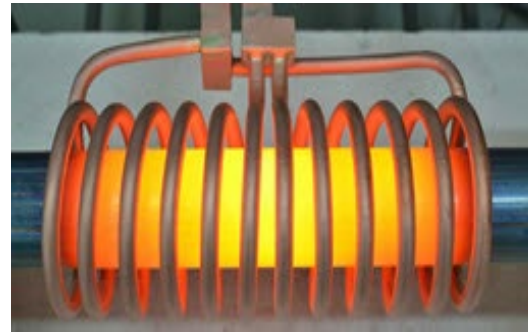

Heat Treatment

Carbonitration, Gas Cementation, Reclamation, Stress relieving, Tempering, Induction etc. heat treatment operations are carried out under our control by our expert and well-equipped partners.



Surface Production & Coating

Metal, Cathaphoresis, Anodizing, Phosphate etc. with coating operations, age, dust, electrostatic etc. dyeing operations are carried out under our control by our expert and well-equipped partners, using the latest system methods.



Machine Elements

Special Gear, Coupling, Pulley, Bearing etc. machine elements are designed by our R&D and P&D departments and manufactured by our expert technical team in our manufacturing workshops.

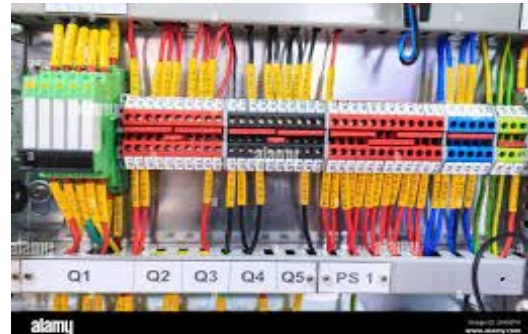

Electric / Electronic / Software

Preparation of electrical circuit diagrams suitable for customer projects with CAD programs, panel assemblies, PLC software, commissioning operations are carried out by our technical service team.



Quality Control

The manufactured workpieces are carried out by our expert technical personnel, with statistical quality control methods and calibrated, state-of-the-art control equipment, during and after the completion of the manufacturing process.

Our Abilities

Installation & Tech. Service



Installation, assembly and training services of the machines we have manufactured as well as the completed project products are provided by our Technical Service team, who are experts in their fields.

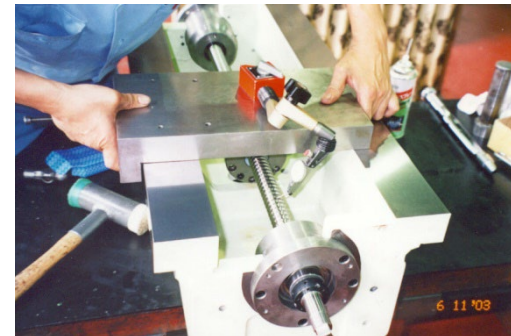



Our Marketing and Sales activities are carried out by our expert technical sales personnel, with the support of digital methods such as advanced CRM software, Commercial and Social media, as well as traditional methods such as Our References, Customer Visits, Fair Participation and Visits.



Total WorkShops : 3

Working Areas : 1.600 m²

Manufacturing (Machining- Construc. -Assbl.- Q.C & Ware H.)	1250m ²
Offices (Techical- Sales – Purch. -Acc. & Fin.)	150m ²
Open Area (Car Parking & Social Area)	200m ²
Total	1600m ²



Personal	Engineer		Technician		Economist		Other		Total		Av. Age
	Wom.	Man	Wom.	Man	Wom.	Man	Wom.	Man	Wom.	Man	
Engineering & Design		2		1					0	3	45
Manufacturing		2	2	13					2	15	30
Quality Control				1					0	1	35
Sales	1			1					1	1	30
Purchasing				1					0	1	40
Account & Finance					2				2	0	35
Auxlarity							1	1	1	1	40
Total	1	4	2	17	2	0	1	1	6	22	36

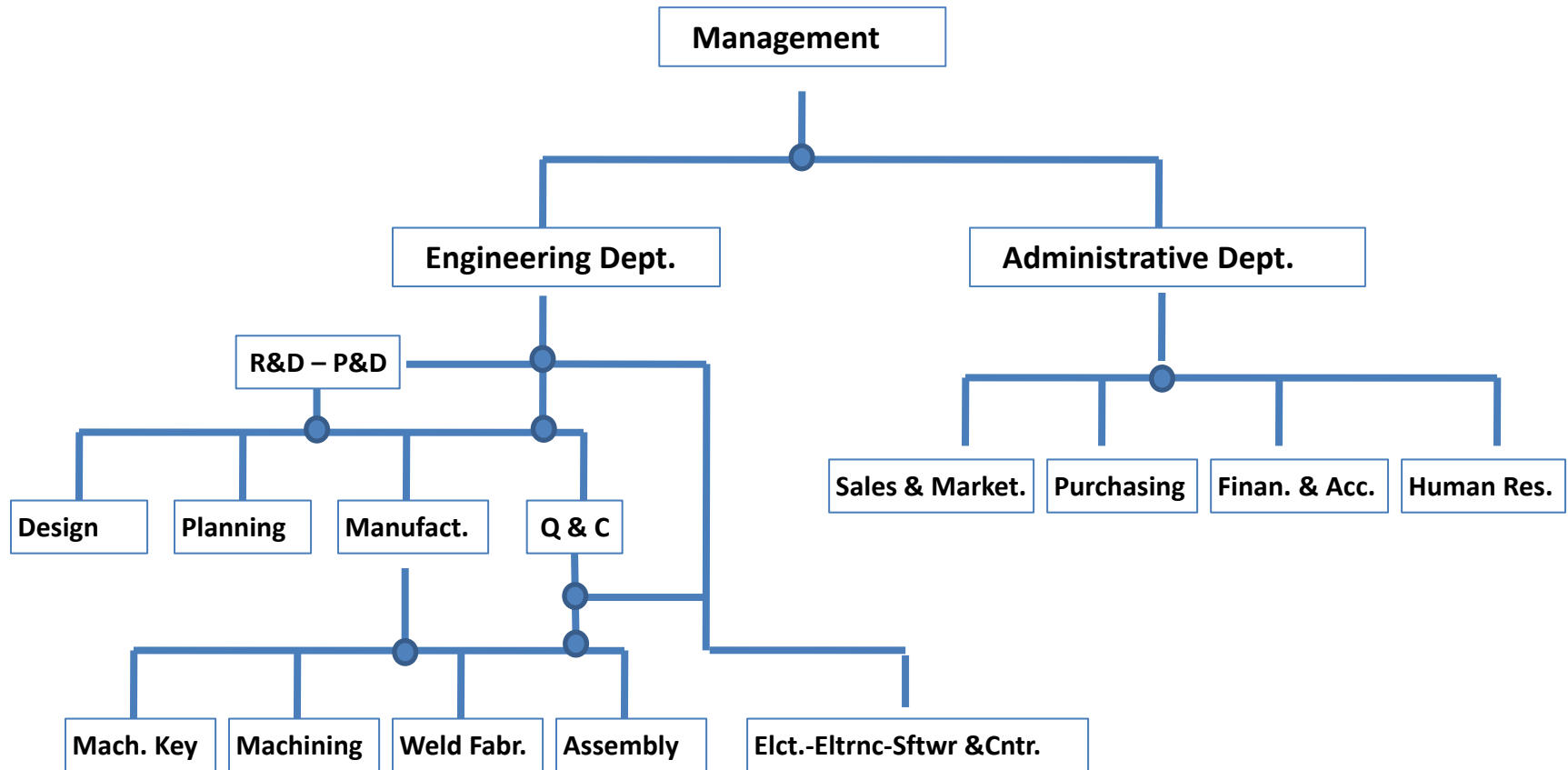
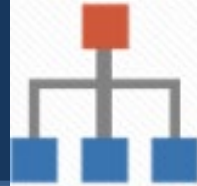

Machine Tool List

Machining Dept. (2/4)

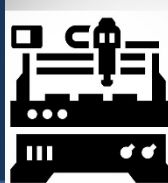

Machine Tools Equipments & Accessories	Techn.	Q'ty pcs. / set	Axes		Trade Mark	Model	Control	Manuf. Year	Origin	Capacity					
			Lin.	Rot.						X Ax.	Y Ax.	Z Ax.	A Ax.	B Ax.	C Ax.
										ø/L (mm)	W (mm)	H (mm)	(°)	(°)	(°)
Turning Machine	CNC	1	2		HYUNDAI		Fanuc	2018	Korea	450		600			
Turning Machine	CNC	1	2		GOODWAY	GCL 2L	Fanuc	2017	Taiwan	280		600			
Turning Machine	CNC	1	2		GILDEMEISTER	CTX 400	Heidenhain	1999	Germ.	350		600			
Turning Machine	CNC	1	2		GILDEMEISTER	CTX 400	Heidenhain	2000	Germ.	350		600			
Turning Mill. Center	CNC	1	2	1	DMG MORI	CTX 310	Siemens	2011	EU	280		500			360
Vert Machinin. Center	CNC	1	3	2	TAKUMI		Fanuc	2015	Taiwan	1000	500	500	360	120	
Vert Machinin. Center	CNC	1	3		HYUNDAI		Mitsubishi	2016	Korea	1100	500	500			
Vert Machinin. Center	CNC	1	3	1	AVEA		Fanuc	2015	Taiwan	1100	600	500	360		
Vert Machinin. Center	CNC	1	3		ARES SEIKI		Mitsubishi	2014	Taiwan	800	500	450			
Vert Machinin. Center	CNC	1	3	2	DMG MORI	DMU 50	Siemens	2014	EU	800	500	500	360	120	
Vert Machinin. Center	CNC	1	3	2	DMG MORI	DMU 50	Siemens	2014	EU	800	500	500	360	120	
Tapping Center	CNC	2	3		ARES SEIKI		Mitsubishi	2014	Taiwan	450	300	350			
Lazer Marking Machine	CNC	1	3		TELESIS		Telesis	2017	Turkey	300	200				

Total

14



Q&C Equipments	Technology	Q'ty	Trade Mark	Origin	Capacity	Unit
3D CMM	CNC	1	Coord 3	Italy	1000x500x500	mm.
Opt. Measr. Projector	Digital	1	Mitutoyo	Japan		
Plate & Stand	Granite	1	Tesa	Swiss	1000x600	mm.
Plate & Stand	Cast Iron	1	misc.		800x500	mm.
Height Gauge	Mechanical	1	misc.		800	mm.
Height Gauge	Digital	1	Mitutoyo	Japan	600	mm.
Calipers (0 - 750 mm)	Mech	15	misc.			
Calipers (0-300 mm)	Digital	15	misc.			
Micrometers (0-250 mm)	Mechanical	20	misc.			
Micrometers (0-750 mm)	Digital	7	misc.			
Dial Gauges (0,01 - 0,001)	Mechanical	15	misc.			
Dial Gauges (0,001)	Digital	3	misc.			



Welded Fabrication	Technology	Q'ty	Capacity	Unit
Welding Machine	Inv. Electrode	1	400	A.
Welding Machine	AC Electrode	1	50-400	A.
Welding Machine	Mig-Mag	2	60-500	A.
Welding Machine	Inventer TIG	1	5-500	A.
Welding Plate & Stand		1	2000x1000	mm.

Hand Tools	Technology	Q'ty	Capacity	Unit
Drill Machines	Hand Tools	5	misc.	
Grinding Machines	Hand Tools	5	misc.	
Drill & Mill. Tool Grinder	Conventional	3	misc.	
Drill & Mill. Tool Grinder	Conventional	1	misc.	
Chamfering Machine	Conventional	1	misc.	

Handling / Transport. & Others	Technology	Q'ty Pcs.	Trade Mark	Origin	Capac.	Unit
Forklift	Disel	1	Komatsu	Japan	3	ton
Cranes	Electricity	2	Guralp	Turkey	5	ton
Commercial Vehicle	Disel	1	Fiat	Turkey	500	Kg.
Commercial Vehicle	Disel	1	Fiat	Turkey	1000	Kg.
Commercial Vehicle	Disel	1	Ford	Turkey	2000	Kg.
Air Compressor	Screw Type	3	Komsan	Turkey	8	Kg/cm ²



Softwares	User Dept.	Licence /User Q'ty	Manufactur.	Origin
Autodesk Inventor Prof.	Engineering	1	Autodesk	USA
Solid Works Premium	Engineering	1	Dassault	France
Solid Cam	Eng. & Manuf.	2	Dassault	France
Matlab	Engineering	2	MathWorks	USA
ERP (Enter. Resour. Plan.)	All Dept.	5	Logo	Turkey
CRM (Custom. Rel. Man.)	Sales & Accou.	10	Logo	Turkey
WMS (Ware House Man.)	All Dept.	5	Logo	Turkey

Certificates	Q'ty	Validity Date	Authorised Institioun
ISO 9001	3	Misc.	FQC – TUV - KIOSCERT
Trade Mark Regist. Cert.	3	Misc.	Turk. Patent.& TM Office
Usefull Model Certif.	3	Misc.	Turk. Patent.& TM Office
Patent Certificate	1	15.02.2027	Turk. Patent.& TM Office
Occupation. Healt & Safe.	1	04.06.2022	Ministry of Labor Social Security
CE Ceriticates	3	Misc.	Turkish Standart Instiution



Turnover	2021	2022	2023
	Euro	Euro	Euro
Domestic (D)	1.100.000,00	1.326.000,00	1.502.000,00
Export (E)	175.000,00	232.500,00	282.500,00
Total (T)	1.275.000,00	1.558.500,00	1.784.500,00

Rates	2021	2022	2023
Rate of D/T	86 %	85 %	88 %
Rate of E/D	14 %	15 %	12 %



Referances of Domestic Comp.	Sector	Remark
Dirinler A.S.	Machine Tools	Machining / Project
CMS A.S.	Automotive	Machining / Project
Triad	Automotive	Machining / Project
Volt Motor	Electric	Machining / Project
Gimas A.S.	Engineering	Machining / Project
UK-Cast Ltd	Machine Manufact.	Machining / Project
Gulermak A.S	Steel Contrction	Machining / Project
Enercon	Energy	Machining / Project
Nurol A.S	Deffence	Machine Tools
IDC A.S.	Steel Ind.	Mach. Tools.& Machining

Export Countries	
Germany	Italy
Holland	Bulgaria
Russia	Ukranie
Romenia	Azerbaijan
Kazakhstan	Georgia
Iranian	Iraq









- 1-Combining our 3 different workshops in a closed area of 5000 m²
- 2- Increase our machining capacity with new machine tools
- 3- Increase our machine key production to approx. 15.000.000 pcs./year (With New technology we have devolpped for key manufacturing)
- 4- Adding sheet metal processing to our manufacturing capacity with one Laser Cutting machine & Bend Press Brake
- 5- To initiate domestic and international marketing and sales activities of our patented product.
- 6- Increasing our export/turnover ratio between %30-%40

Applied & Planned certifications

- 14001 – Environmental Management System
- 18001 – Occupational Healt & Safety Management System
- 10002 - Customer Satisfaciton Management System
- 28000 – Supply Chain Security Management System
- 31000 – Risk Management System
- CE – To our new products



Our group carries out activities with the aim of controlling environmental impacts and sustainable production in all its units for a more livable world.

Sustainability Components		Our Activities
Set Up & Approach		The areas outside the workshops are designed to provide comfort during breaks and lunches for our employees. Fresh four-course Mediterranean-inspired lunches are cooked daily in our kitchen, while vegetables are sourced from the local farmer's market and meats from small suppliers rather than chain stores. Our group strongly encourages our employees to take maternity leave in addition to their days off. Besides, we donate for seedlings to Turkish Foundation for Combating Erosion, Afforestation and Conservation of Natural Assets.
Energy		Solar energy systems have been installed to our roofs to supply warm water. We prefer motion sensor lights in the corridors and toilettes and the light bulbs are all energy saver type. The locations of the office rooms and common areas for staff are located in order to benefit sun light throughout the day.
Waste		Our group collects the non-hazardous wastes separately at the source and delivers them to the licensed collector or the subcontractor of the municipality. Hazardous wastes are collected in separate compartments according to their types in our temporary waste storage area before they are delivered to the licensed collector.
Water		Sensored taps and urinals are used in the toilettes, as well as two level flushes. Required permits are already taken to discharge wastewater to the centralized sewage system supplied by the municipality. Rainwater harvesting system from roofs are planned to be installed in short term.
Transport		Some part of our staff are using public transport to arrive workshops, while about half of them are using our carpool system; every day three of our vehicles collect the staff from their homes and deliver back at the end of the working hours.
Education & Research		Our group wants its managers and employees to develop in the field of environment and sustainability, and this is achieved with the support of Dokuz Eylül University Sustainability Office. Our group, which has been carrying out joint studies with universities since the past due to our belief in education and research, produced and gifted two pilot anaerobic reactors with a volume of 200 L to Dokuz Eylül University, and also produced 20 free-of-charge kinetic test trial systems to be used in mine waste characterization.



Enerji Sistemleri
Energy Industry



Havacılık Sanayii
Aviation Industry



Savunma Sanayii
Defense Industry



Gemi İnşaa Sanayii
Ship Building Industry



Kalıp İmalatçıları
Mould Makers



Makina İmalat Sanayii
Machine Manufacturing Industry



Otomotiv Endüstrisi
Automotive Industry



Uzay Sanayii
Space Industry



Samples Our Products

Machining / Contract Manufacturing





Made by our Machining partners





Made by our Machining partners

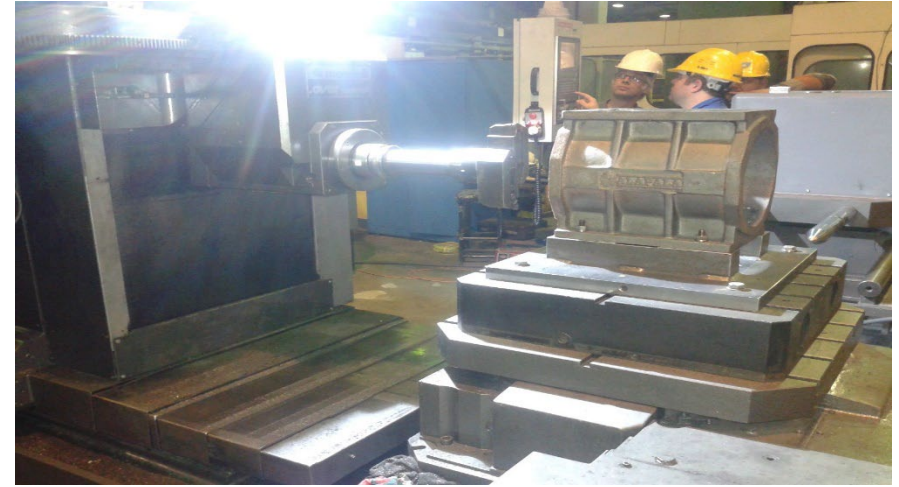



Hydraulic Cylinders Manufacturing According To Customer Requirements

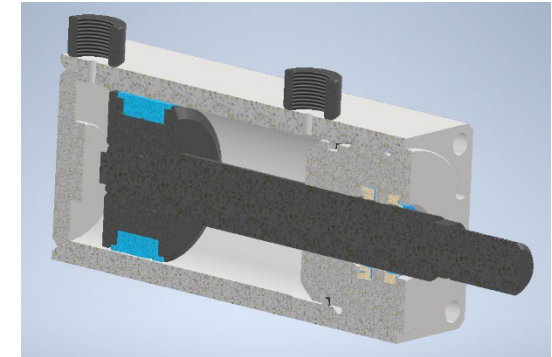

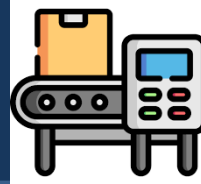

CNC Rotary Table



Tapping Machines



Drill Grinder Machine

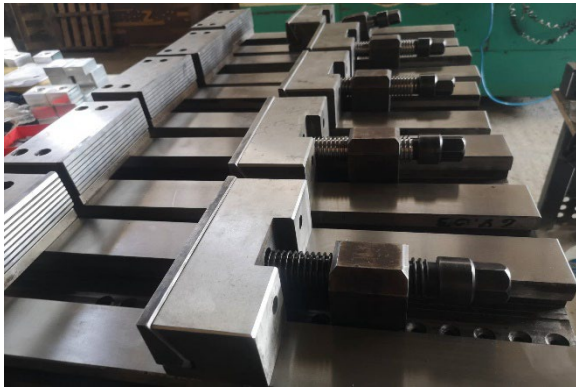

Accurate Vises



Packing Sample Of Products

Latest Products

Family of Air & Surface
Disinfection Equipments



Patented & Best Academic
Invention Award



Some Exam. of Our Completed Projects

According to Customer Requirements



BioGas Reactor



Loading / Unloading Robot



Multi Drill & Tapping Mach.



Light Type CNC Router Machine



Heavy Type CNC Router Machine

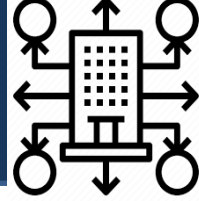

Machining Plant 1



Machining Plant 2



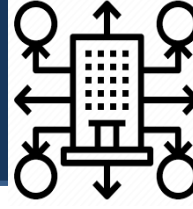

Machine Key & Keyway Line

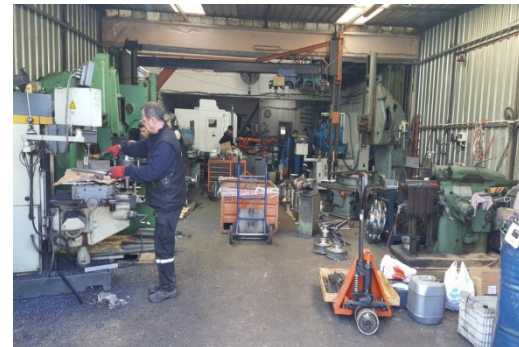

Assembly Lines



Hydraulics



Mechanics



Electricity

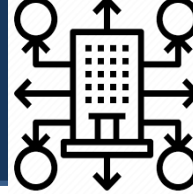

Others



Ware House



Quality Control



Welded Fabric.

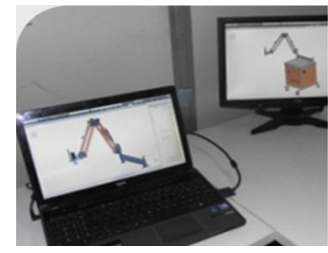

Designe

Offices

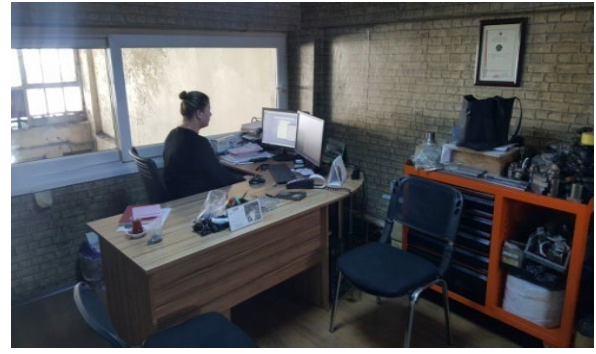

Engineering & Administrative

Overview of Workshops & Our Colleague



Workshop 1 (Key & Keyway)



Workshop 2 (Machining)



Workshop 3 (Machining & Manufacfac.)



Our Values (From Plant 3)



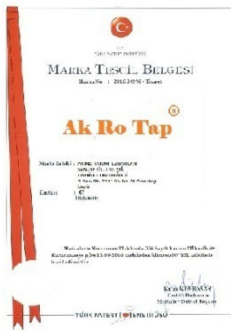

T.C. İÇİŞLERİ BAKANLIĞI
MİLLÎ İHTİSAP VE TEKNOLOJİ BAKANLIĞI
Sanayi Cenet Müdürlüğü

SANAYİ SİCİL BELGESİ

Bölge Tarihi	30/12/2014	Bölge No	05522	Ünvanı / Subesi	Ünvan Değişimi#	Vergi No	5510019110
İşyeri İşletme Ünvanı	AKINCI TAKIM TEZGAHLARI SANAYİ VE TİCARET LİMİTED ŞİRKETİ						
İşyeri Adresi	KEMALPAŞA MAHALLESİ 7419 SOKAK NO 33A DORNOVAİZMİR						
Kayıtlı Bulunduğu Mevkiat Odası	HİTİP MİR EKİPSİ SANAYİ ODASI	Kuruluş Tarihi ve Ticaret Sicil No	30/12/2014	11254			
Kapasite Raporu Birlik Onay Tarihi ve No	23.01/2012 1382	Ticaret Sicil Gazetesi Tarihi ve Sayısı	15/05/1997	4280			
Özet Konusu	KESME VE FORMLAMA, ÇİCİSİ PİM MFRREZİ, ÇİCİ FORMLA TEZGAHI, İDİROLKULUVALI ÇEKME MAKİNASI, PİNGOMATİK KULUVALI ÇEKME MAKİNASI						

Yükseklik hüviyeti yazılı e-iletme 24.04.1997 tarih ve 8548 Sayılı Kanunun İkinci Maddesi gereğince tasat edilmiştir.
Bu belgeyi düzenleyen yetkilinin imza ve stampli ile onay edilmiştir.

CERTIFICADO • ZERTIFIKAT • CERTIFICATE • CERTIFIKAT • CERTIFICATE • CERTIFIKAT

CERTIFICATE

Du Sertifika / This Certificate

UMUT KAMA MAKİNE İMALAT DIŞ TİCARET SANAYİ VE TİCARET LİMİTED ŞİRKETİ

Firmasının / Ofise Company

Evka 3 Mah. 129/8 Sokak No: 24 Dornova / İzmir / Türkiye

Adreslerinde bulunan testlerin KIOSCERT Belgeleme tarafından denetlenmiş ve Kalite Yönetim Sisteminin The facilities at the addresses have been audited by KIOSCERT and Quality Management System

ISO 9001:2015

Şartların aşağıdaki kapsamda uygulanmakta olduğu gözlemlenmiştir.
It has been observed that the conditions are applied within the following scope

Belgeleme Kapsamı / Certification Scope

METAL KESME ŞEKİLLENDİRME TAKIM TEZGAHLARININ PARÇA VE AKSESUARLARI İMALATI
METAL CUTTING AND FORMING MACHINE TOOLS PARTS AND MANUFACTURE OF ACCESSORIES

Sertifika Numarası - QMS-23-010-TM1T
 Certificate Number
 Sertifika İl Yayın Tarihi - 02.02.2023
 Certificate Issue Date
 Sertifika Yayıncı Tarihi - 03.03.2023
 Certificate Release Date
 Sertifika Geçerlilik Tarihi - 01.02.2025
 Certificate Validity Date
 Sertifika Revizyon No ve Tarihi / No /
 Certificate Revision Number and Date
 Belgeleme Personeli İmza Tarihi - 01.02.2023
 Certificate Person and Date

KIOSCERT Uluslararası Sistemlerin Ölçüm Belgeleme Sistemi ve Eğitim Kurumları Ltd. Şti.
 İmza Mah. 02/03/2023 No: 3 B/C 2-4 Family Park-2 Şişli Katıyolu - Etiler - Beşiktaş - İstanbul - Türkiye
 Certificate No: 02/03/2023 No: 3 B/C 2-4 Family Park-2 Şişli Katıyolu - Etiler - Beşiktaş - İstanbul - Türkiye
 KIOSCERT is a member of the International Association of Certification Bodies (IACB)

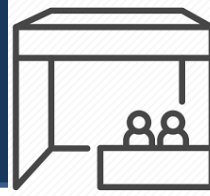



TIMETURK

<https://www.timeturk.com/deu-de-atik-maske-ve-eldivenlerin-guvenli-sekilde-toplanmasini-saglayan-cihazin-ilk-uretimi-yapildi/haber-1628503>

**HABER
TURK**

<https://www.haberturk.com/deu-de-atik-maske-ve-eldivenlerin-guvenli-sekilde-toplanmasini-saglayan-cihazin-ilk-uretimi-yapildi-2793611>

Hürriyet

<https://www.hurriyet.com.tr/teknoloji/atik-maske-ve-eldivenleri-guvenli-sekilde-toplayan-cihaz-gelistirildi-41603352>

ekspres

<https://www.haberekspress.com.tr/teknoloji/deu-de-atik-maske-ve-eldivenleri-toplayacak-cihazin-ilk-uretimi-h136135.html>

**RHA
AJANS**

<https://rhaajans.com/haber/9400927/deun-un-virusu-yok-eden-cihazi-patent-aldi>



www.egenettv.com/deuden-coronanın-bulasma-riskini-azaltan-cihaz/



www.kamupress.com/saglik/virusu-yok-eden-cihaz-patent-aldi-haberi-10090



<https://haber.deu.edu.tr/deuden-coronanın-bulasma-riskini-azaltan-cihaz/>

Some of Our Partners



GIMAS

<https://www.gimas.gen.tr/>

CMS

<https://www.cms.com.tr/en>

TOSYALI

<https://www.tosyalimakina.com/en/>

Yaka Döküm



<https://www.ors.com.tr/>



<https://www.simyametal.com.tr/>



<http://afeolgunlar.com.tr/>



<https://brtmakina.com/>

EGE ELOKSAL

<https://www.egeelokal.com/d/Tr>

Bodycote

<https://www.bodycote.com/tr/>



dirinler since 1952

<http://www.dirinler.com.tr/home>



<https://cevre.deu.edu.tr/tr/>



<https://www.depark.com/en>



dirinler
Döküm Sanayi ve Ticaret A.Ş.

<https://www.dirinlerdokum.com/>

SIEMENS

<https://new.siemens.com/tr/tr.html>



<http://ia.delta-turkey.com/index.html>

OMRON

<https://omron.com.tr/tr/home>



<https://www.meanwell.com/>



Mr. Metin AKINCI

- Mechanical Engineer
- Graduated Istanbul Technical University – Mechanical Engineering
- Founder & President of Akinci Machine Tools LTD.
- Founder, Vice President and Technical Director of Imtek A.S.
- Technical Advisor of Umut Kama LTD.
 - Born in 1970 in Istanbul/Turkey
 - Married and has 3 children



Mr. Ibrahim TURANLI

- Mechanical Technician
- Graduated Technical High School
- Founder & Managing Director of Umut Kama LTD & Imtek A.S.
- Born in 1980 In Izmir / Turkey
- Married and has 2 Children



*Thanks for Your Interest to Our Companies.
We Would Like to Long Time Cooperate
with You*

*İbrahim Turanlı
Managing Director*

*Metin Akinci
Technical Director*



Pls. Scan For Our
Web Page



Pls. Scan For
Presantation